



Create lots of storage and workspace in your office or den with this 60" cabinet. It features 1 door with a shelf and pull-out tray for easy access. These cabinets are designed to be built with the beginner in mind with simple pocket hole joinery.

MWA Woodworks and its affiliates are not responsible for any damages that may come to persons or properties involved during the creation or use of this project or plans. The use of these plans and construction of this projects is acknowledgment that you as the fabricator assume all liability for proper construction and safe use of the project through all stages.



WOODWORKS

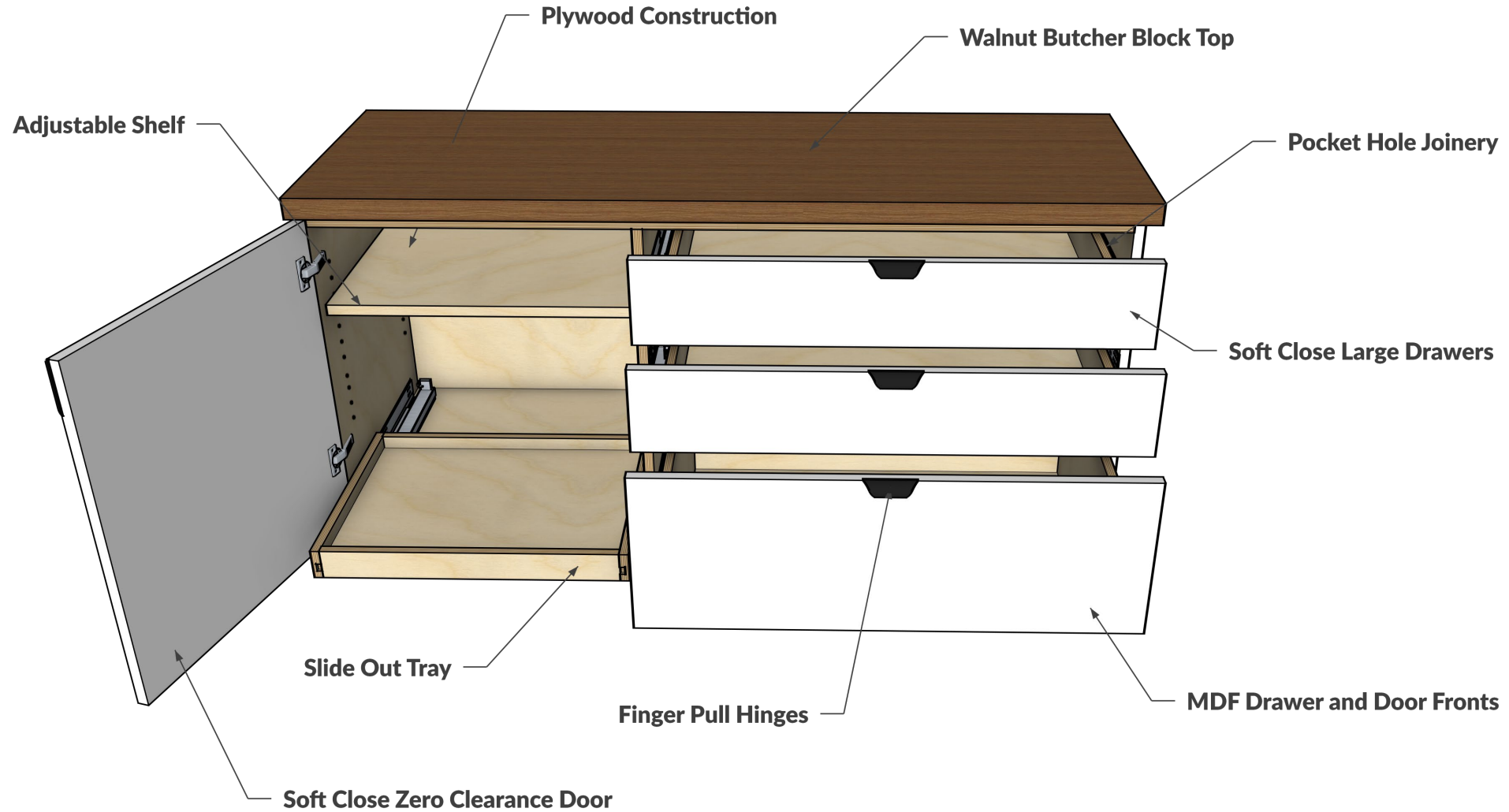

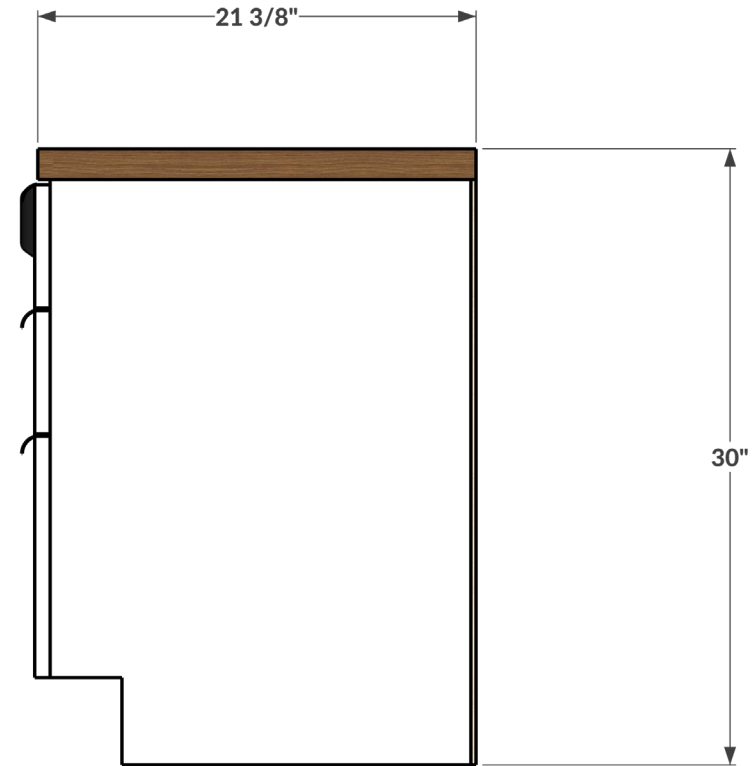
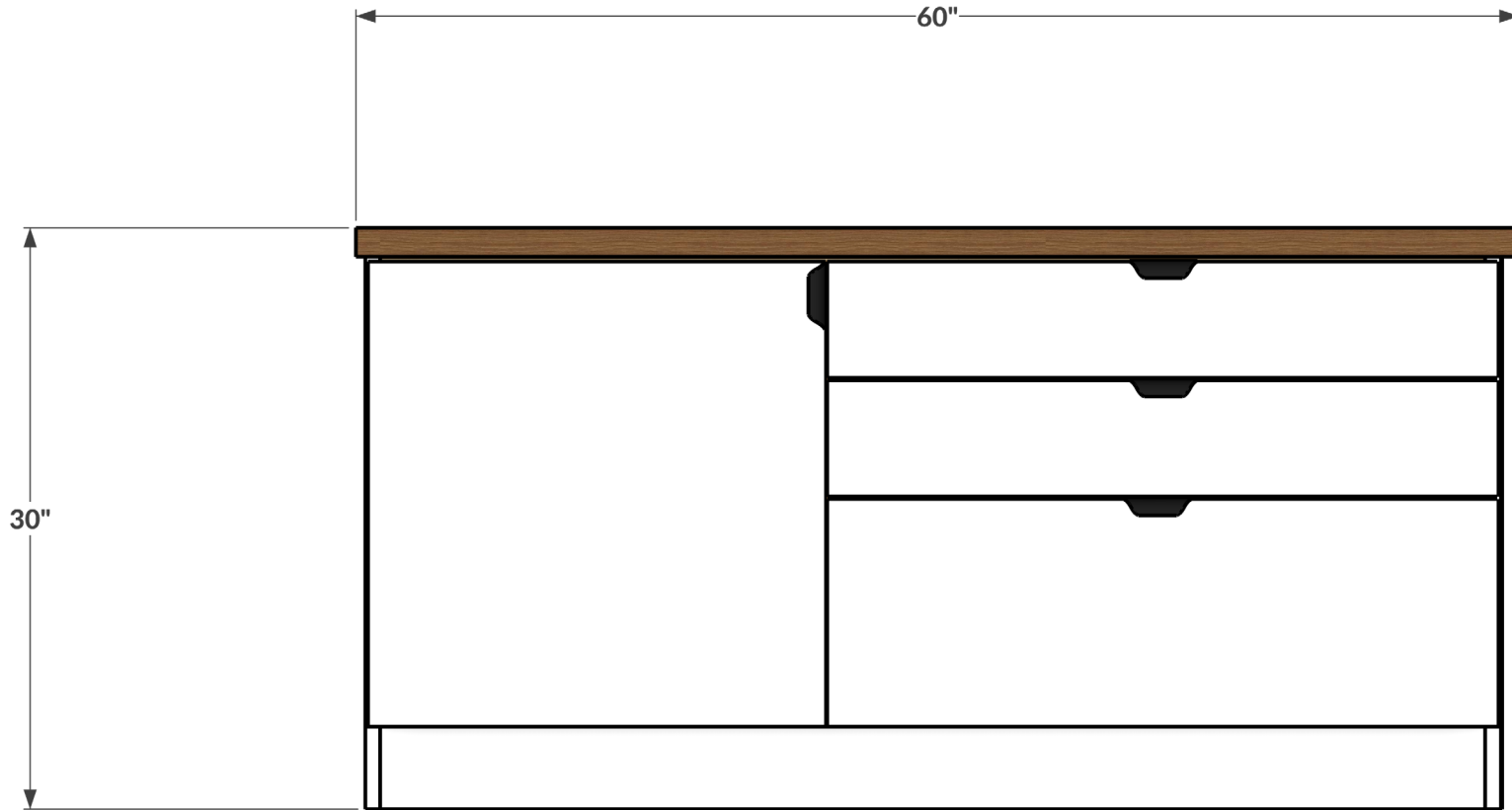

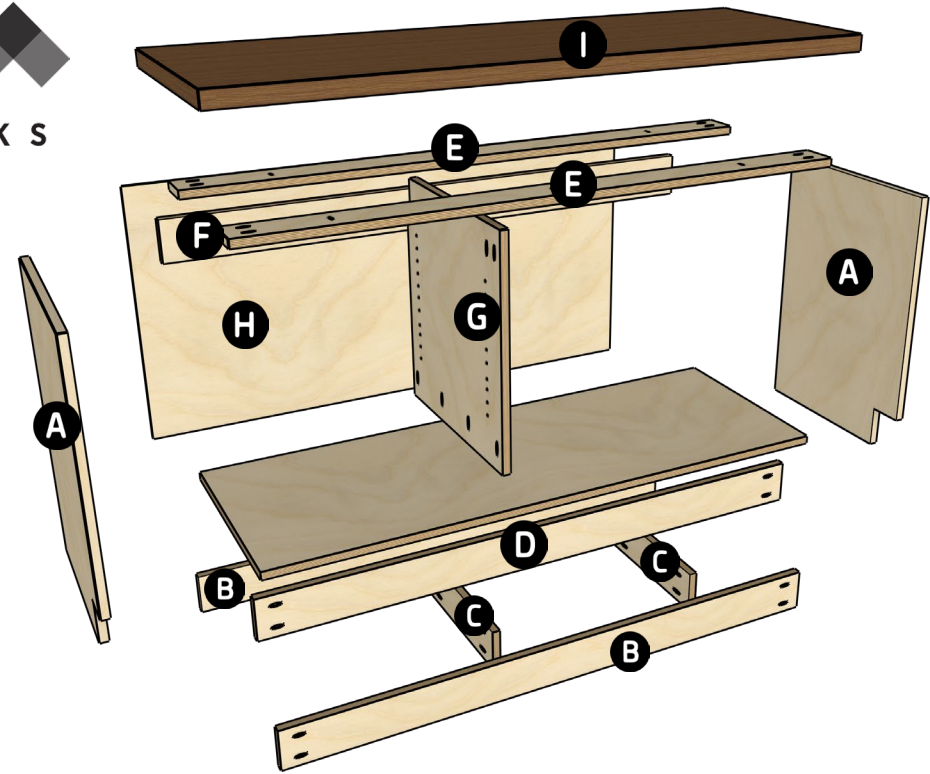

Material List		
Item	Qty.	URL
18" undermount drawer slides	4	https://amzn.to/3DMBNdh
Zero Clearance Door Hinges	1	https://amzn.to/3WfLebg
Edge Mount Door Pulls	4	https://amzn.to/4eldrPx
Pocket Hole Jig	1	https://amzn.to/3N4MBET
Countersink Drill Bit	1	https://amzn.to/470sErO
Bora Centipede Work Platform	1	https://bit.ly/bora-centipede
Track Saw	1	https://amzn.to/40sSgfv
Track Saw Square	1	https://bit.ly/rail-squares
Carpenter's Speed Square	1	https://amzn.to/4cLPgh0
Jig Saw	1	https://amzn.to/474WMI0
1/8 & 1/4 Drawer Front Spacer Brackets	1	https://bit.ly/spacer-brackets
Mag Switch	1	https://amzn.to/4cJVmyD
3/4" Prefinished Plywood - Full Sheet	2	Local Dealer
5/8" Prefinished Plywood - Full Sheet	1	Local Dealer
3/4" MDF	1	Local Dealer
Butch Block Top	1	Local Dealer

Carcass Cut List					
Designation	Qty.	Length	Width	Thickness	Material
(A) Sides	2	28 1/2"	20 1/2"	3/4"	Plywood
(B) Bottom Stretchers	2	57"	4 1/4"	3/4"	Plywood
(C) Base Supports	2	15 1/2"	4 1/4"	3/4"	Plywood
(D) Base	1	57"	20 1/2"	3/4"	Plywood
(E) Top Stretchers	2	57"	3 1/2"	3/4"	Plywood
(F) Top Nailer	1	57"	4 1/4"	3/4"	Plywood
(G) Divider	1	22 3/4"	20 1/2"	3/4"	Plywood
(H) Back Panel	1	58 1/2"	28 1/2"	1/4"	Plywood
(I) Butch Block Top	1	60"	21 3/8"	1 1/2"	Butcher Block



WOODWORKS

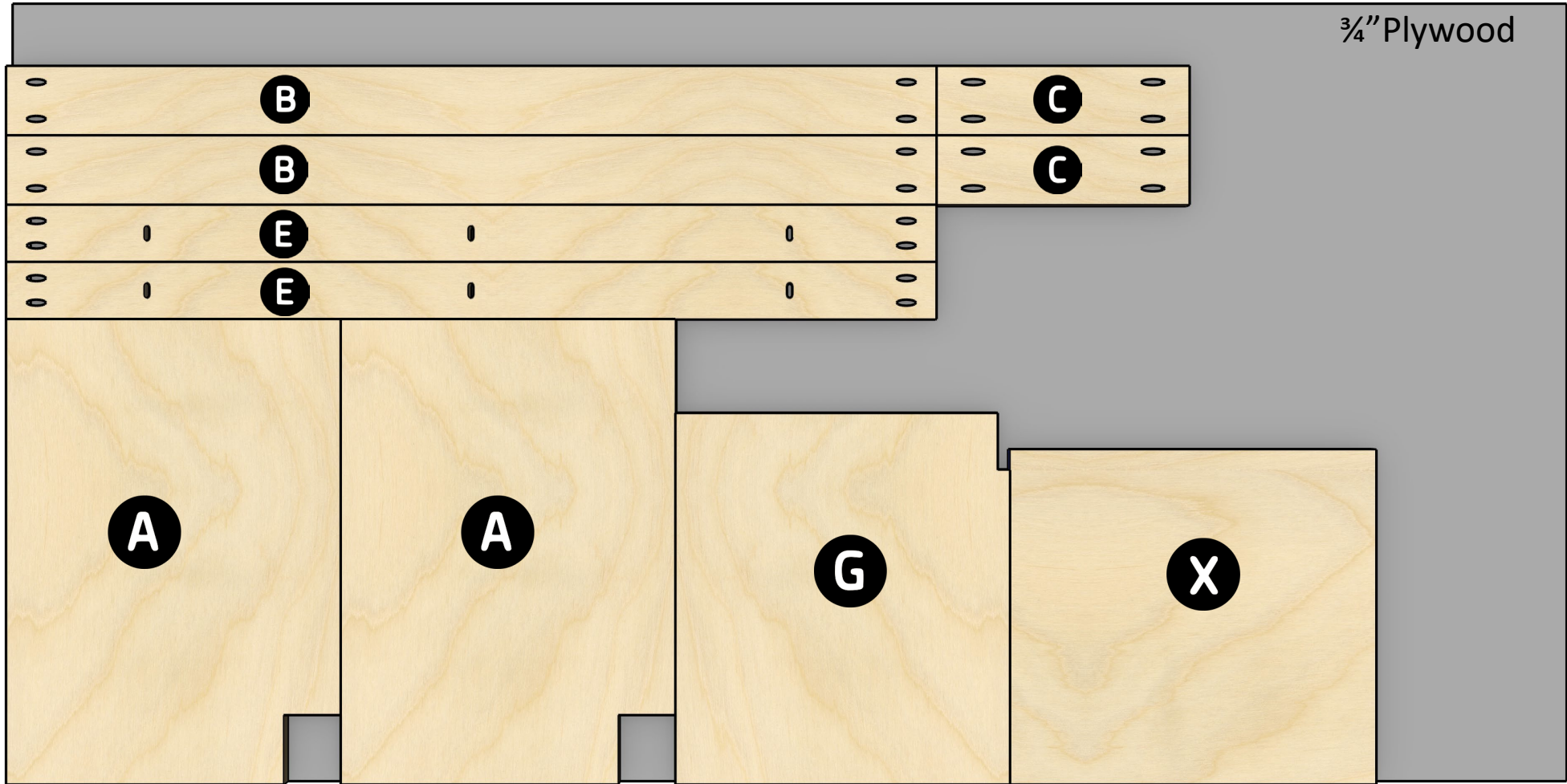

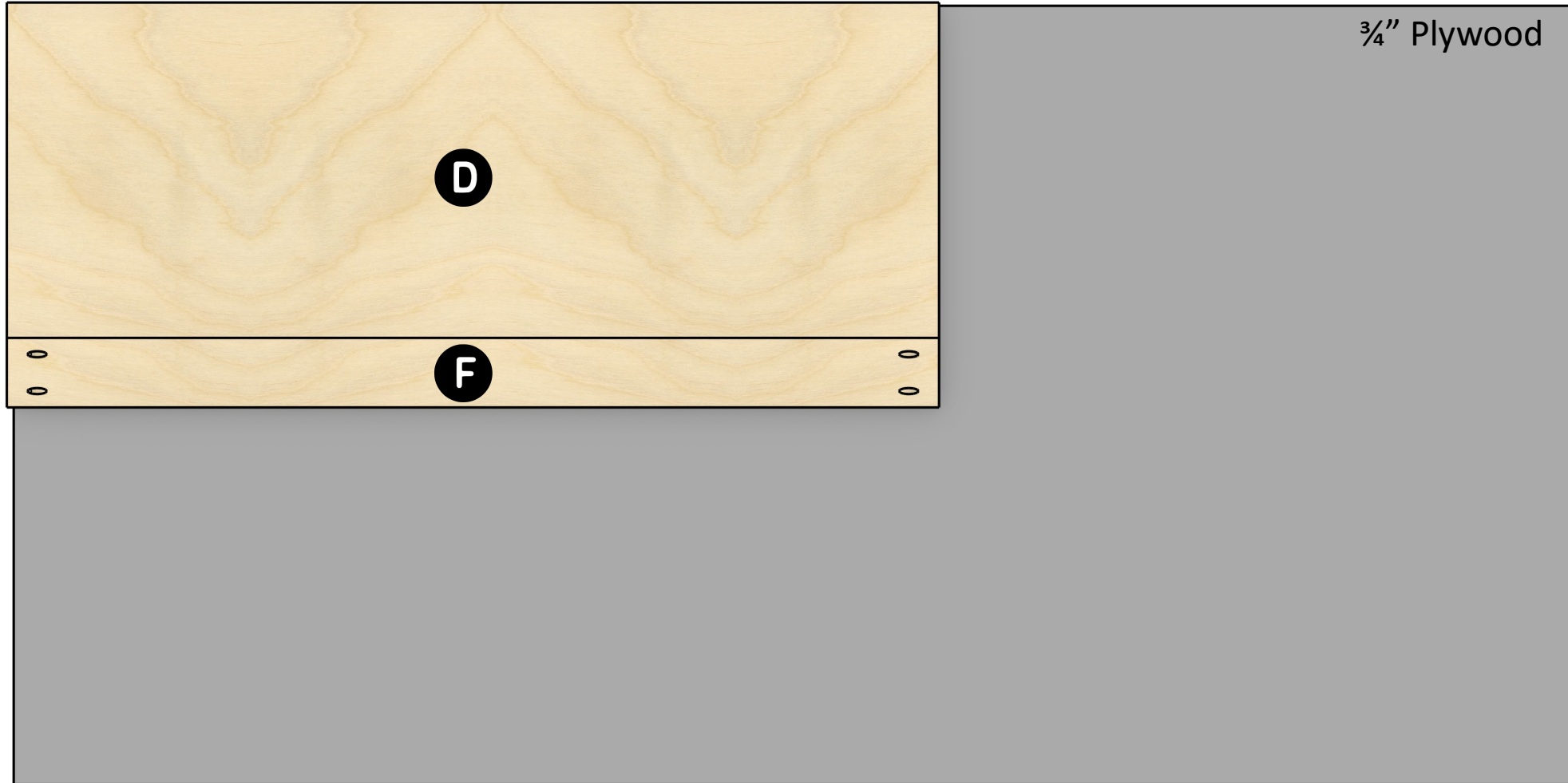

3/4" Plywood

D

F

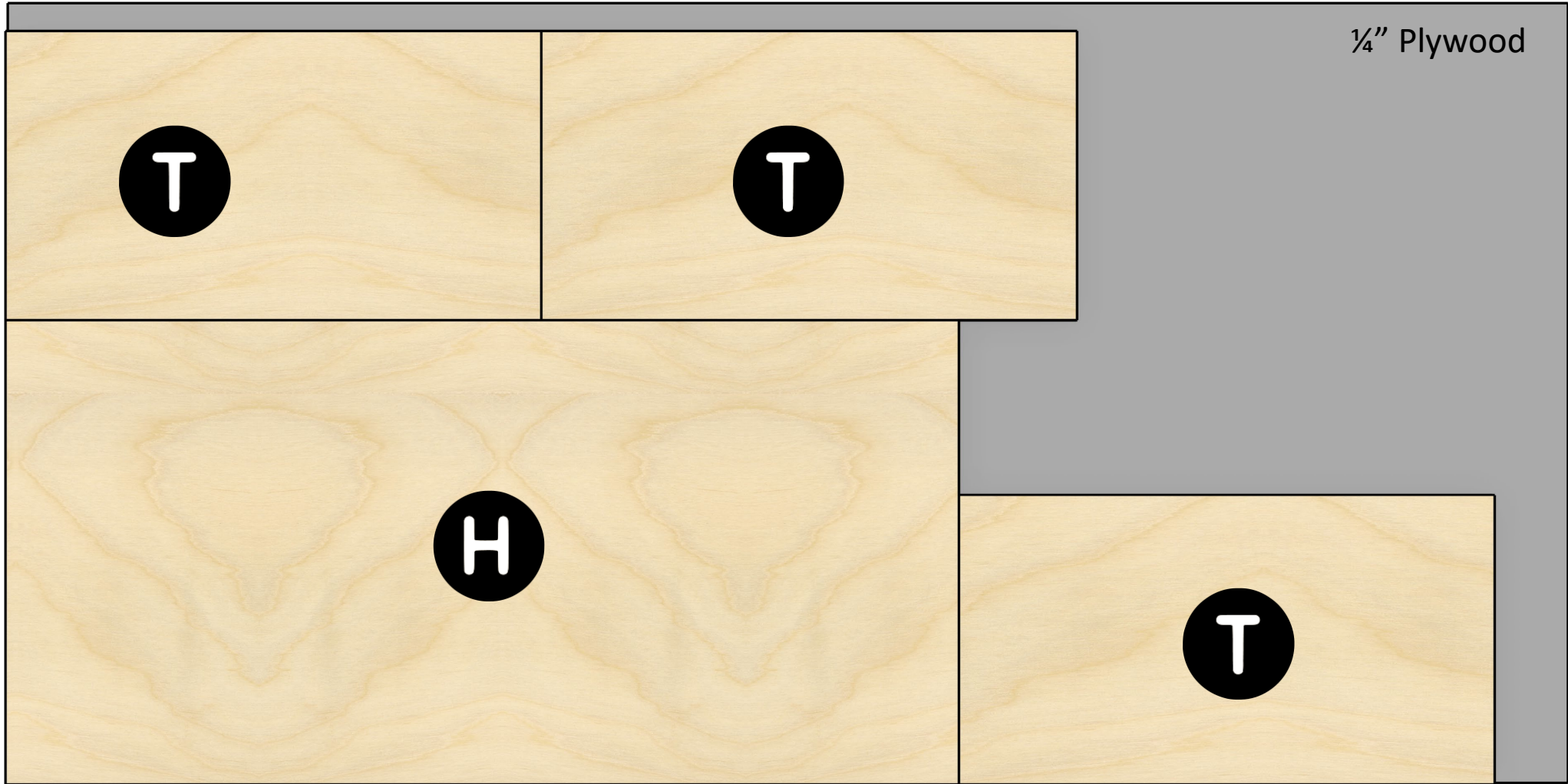

- Mill all parts according to the cut list.
- Cut out the toe kicks from each (A) Sides part.
- The toe kicks are 4 ¼” long x 3 ½” wide
- Cut out the back notches in the (G) Divider.
- The notches are 3 ½” long x ¾” wide.
- Add adjustable ¼” shelf pin holes with that spaced 1” apart starting at 5 ¾” from the top and 2 ½” from the side. The spacing is dependent of your jig you use.
- Make sure the shelf pins are on the inside face of the (A) sides. Make sure the pins on the (G) Dividers are facing the sides.
- Drill pocket holes into the ends of parts B, E, F, C, and the under-side edges of the (D) Base.
- Add 3 equally spaced elongated holes to the (E) Top Stretcher. These holes will provide mounting points for the top that will accommodate seasonal movement. I used a domino joiner, but you can use a drill bit to accomplish the same task.

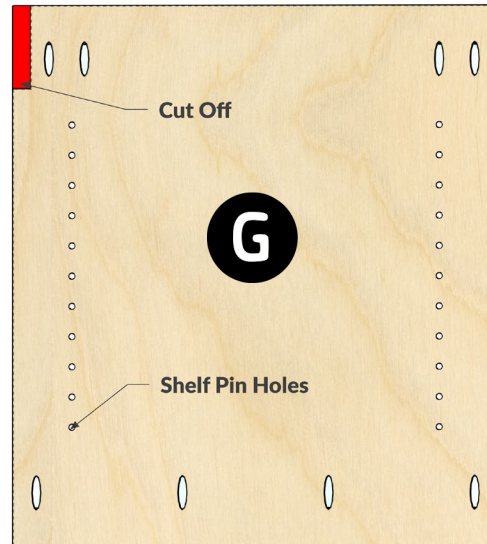
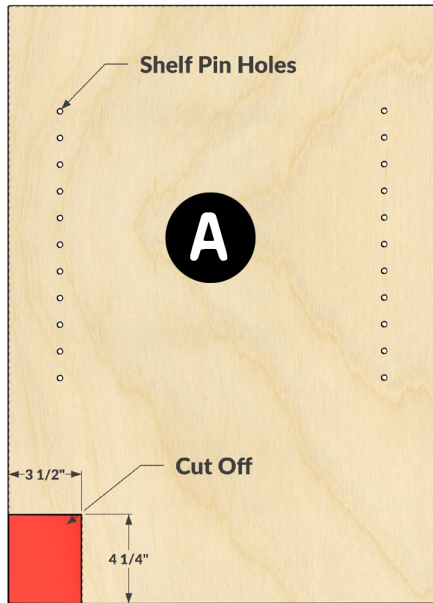
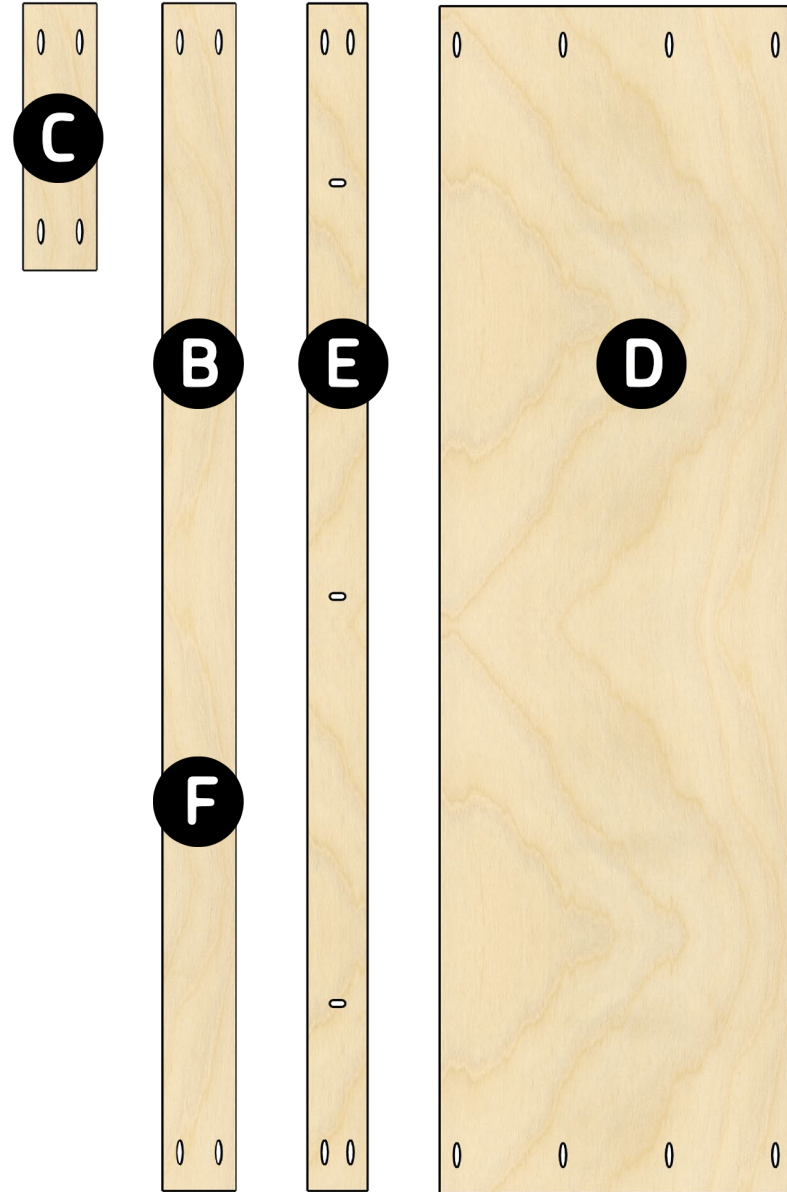

Step 1

- Attach the (B) stretchers to the (A) Sides.
- Note that the front stretcher is flush with the toe kick.

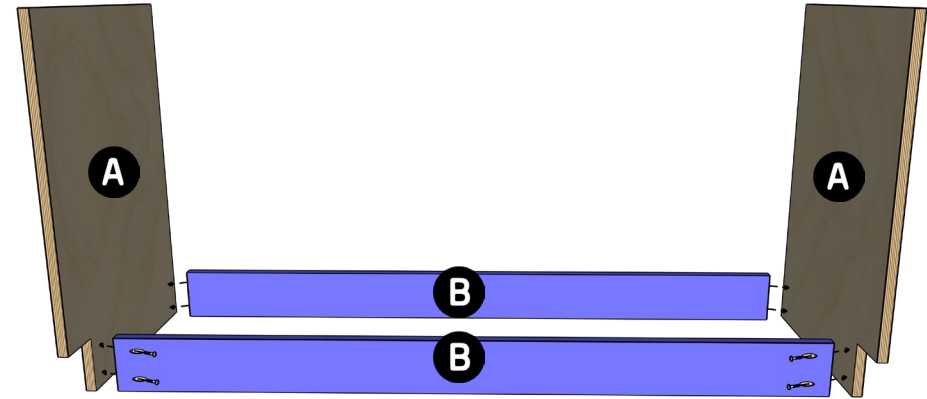

Step 2

- Attach the (C) Base Supports to the inside of the stretchers with pocket hole screws.
- The Supports are spaced out 22 1/2" from left side and 14 1/2" from the right side.

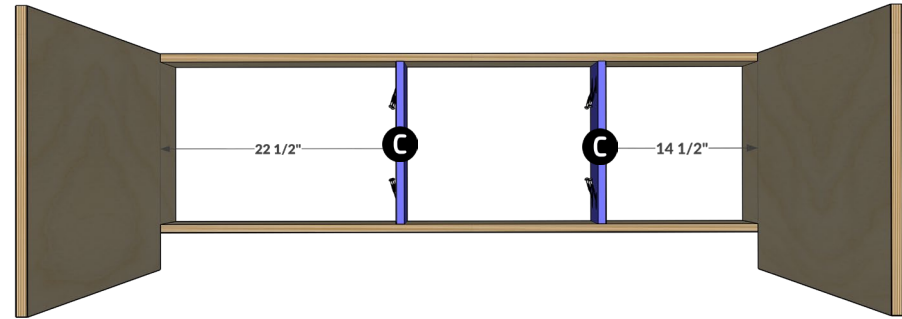

Step 3

- Attach (D) Base to the top of the bottom stretchers. Use equally spaced screws into the long stretchers and into the base supports.
- Pre-drill and counter sink each hole.
- Flip the assembly over and fasten with pocket hole screws in the sides. See inset.

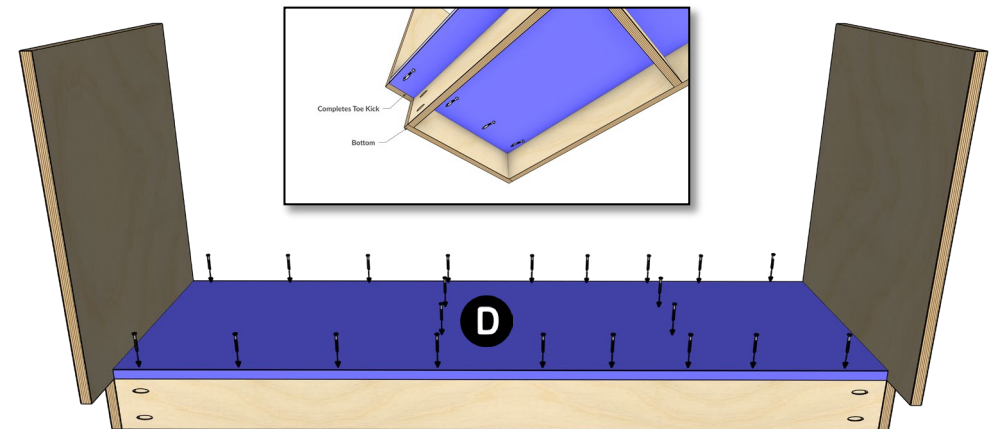

Step 4

- Attach the (F) Top Nailer flush with the top edge of the sides.
- Fasten with glue and pocket hole screws.
- Attach the (E) top stretchers to the (A) Sides.
- Note that the top stretchers are flush with the top corners of the sides and the (F) Top Nailer. Fasten with glue and pocket hole screws.

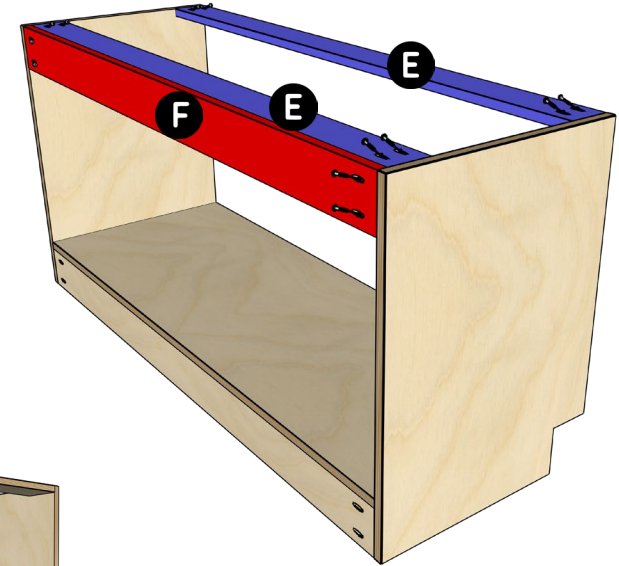

Step 5

- Space the (G) Divider 22 ½" from the sides. It will be in line with the base supports.
- Use a scrap as a spacer.
- Fasten with glue and pocket hole screws.

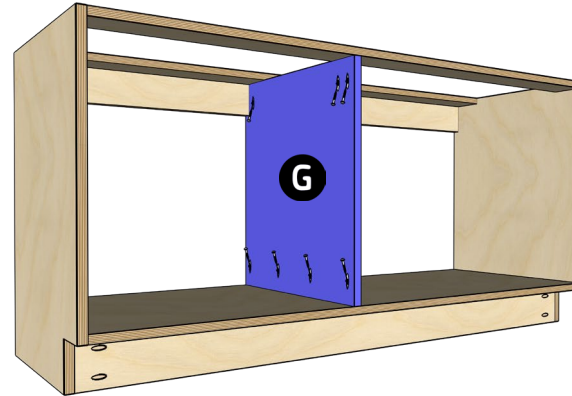

Step 6

- Attach the (H) Back to the cabinet with either brad nails or screws. No glue required.

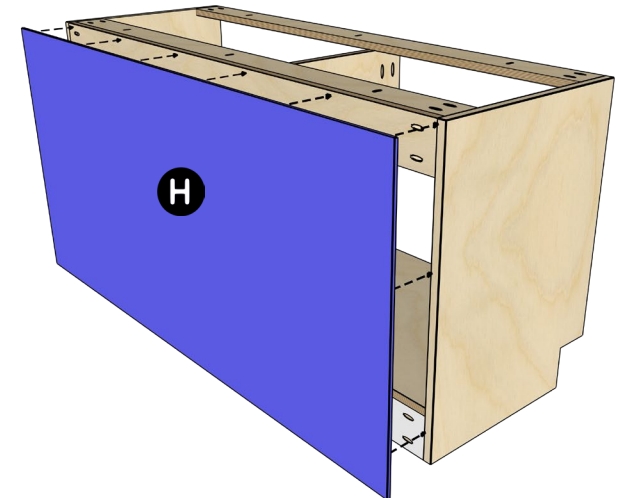

Step 7

- Trim down the butcher block top to 60" x 21 3/8" with a track saw
- Stain the top with your preferred color. I stain mine with a "walnutty" color to make the butcher block section pop a little more.
- Seal the top before attaching it.
- Attach the top to the carcass using screw and washers through the elongated holes in the (E) Top Stretchers that were made during assembly prep.
- The top should be flush with the back and centered on the cabinet.

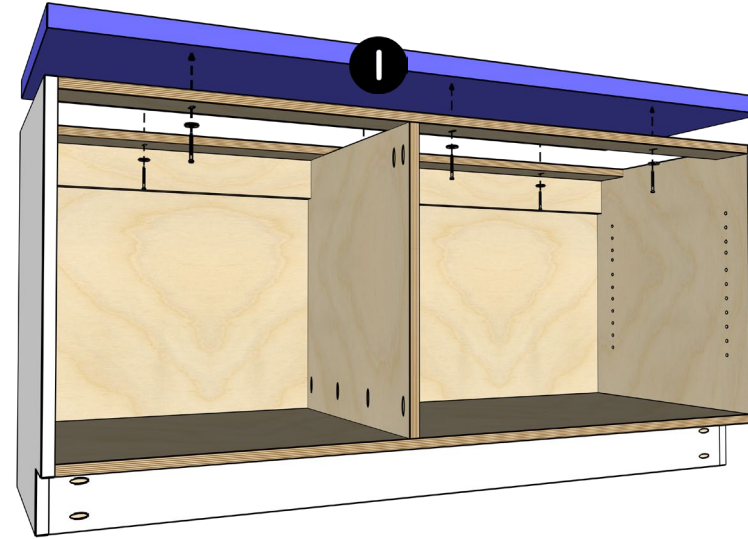

Optional Steps

- Apply edge banding to the exposed plywood sides.
- Use an iron and a roller to apply even pressure and to remove any air bubbles.

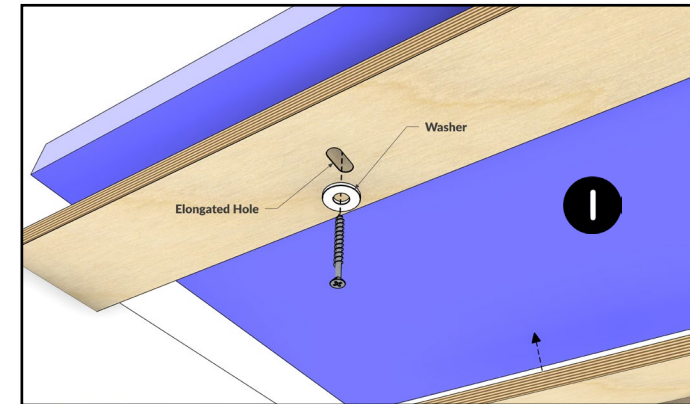

Drawers and Doors Cut List

Designation	Qty.	Length	Width	Thickness	Material
(J) Door	1	24"	23 7/16"	3/4"	MDF
(K) Small Drawer Front	2	34 11/16"	6"	3/4"	MDF
(L) Large Drawer Front	1	34 11/16"	11 3/4"	3/4"	MDF
(M) Tray Back	1	20 7/8"	2 1/8"	5/8"	Plywood
(N) Tray Front	1	20 7/8"	2 1/8"	5/8"	Plywood
(O) Tray Sides	2	18"	2 1/8"	5/8"	Plywood
(P) Tray Bottom	1	21 5/8"	17 1/2"	5/8"	Plywood
(Q) Large Drawer Box Back	1	32 1/8"	9 1/4"	5/8"	Plywood
(R) Large Drawer Box Sides	2	18"	10"	5/8"	Plywood
(S) Large Drawer Box Fronts	1	32 1/8"	10"	5/8"	Plywood
(T) Drawer Bottoms	3	17 3/4"tt	32 7/8"	1/4"	Plywood
(U) Small Drawer Box Backs	2	32 1/8"	3 1/4"	5/8"	Plywood
(V) Small Drawer Box Sides	4	18"	4"	5/8"	Plywood
(W) Small Drawer Box Fronts	2	32 1/8"	4"	5/8"	Plywood
(X) Adjustable Shelves	1	22 7/16"	20 1/2"	3/4"	Plywood

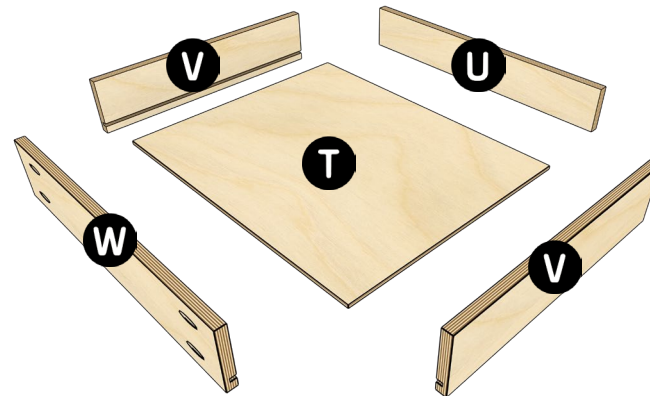
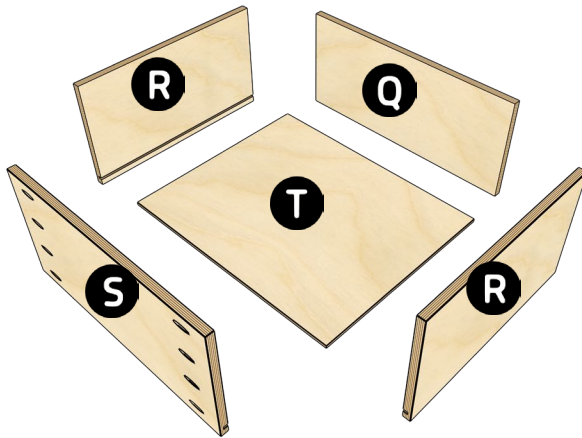
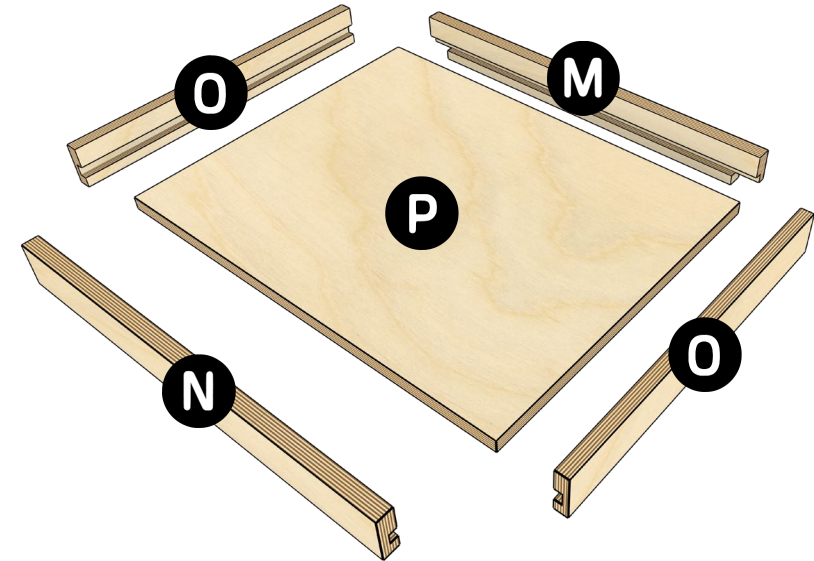
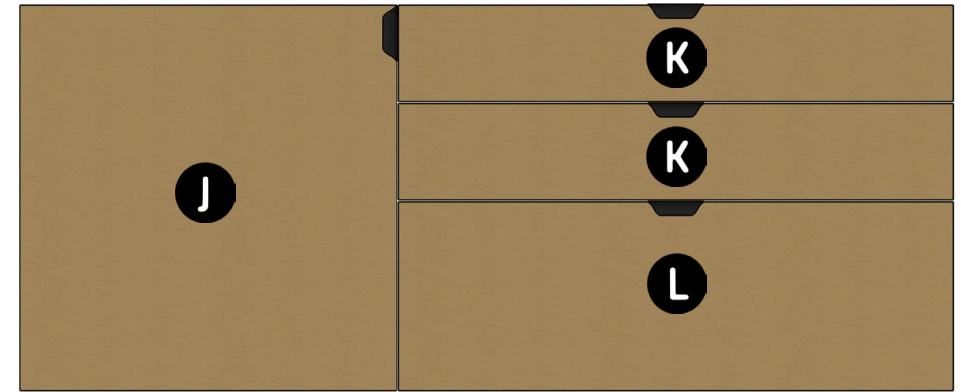

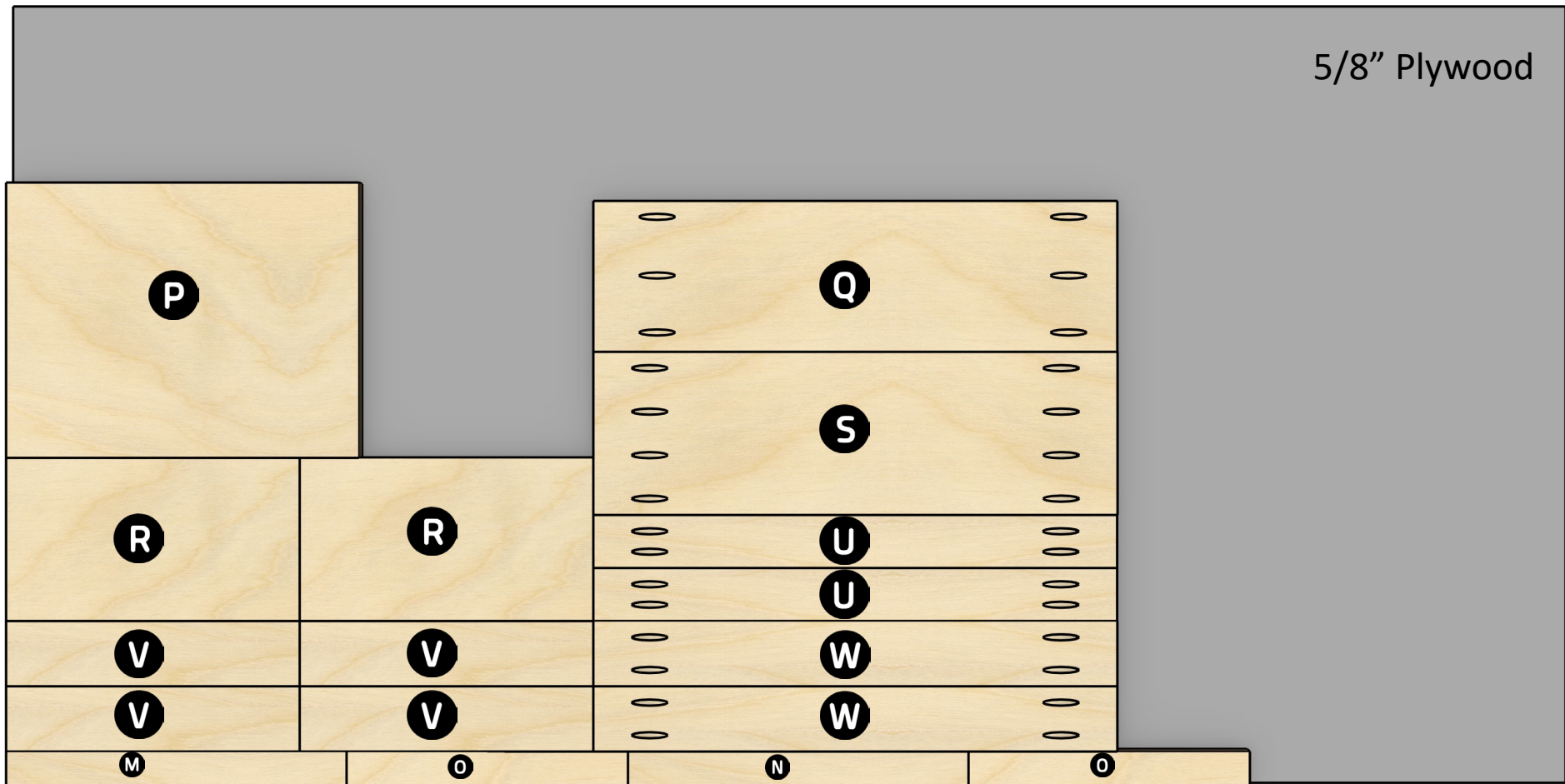

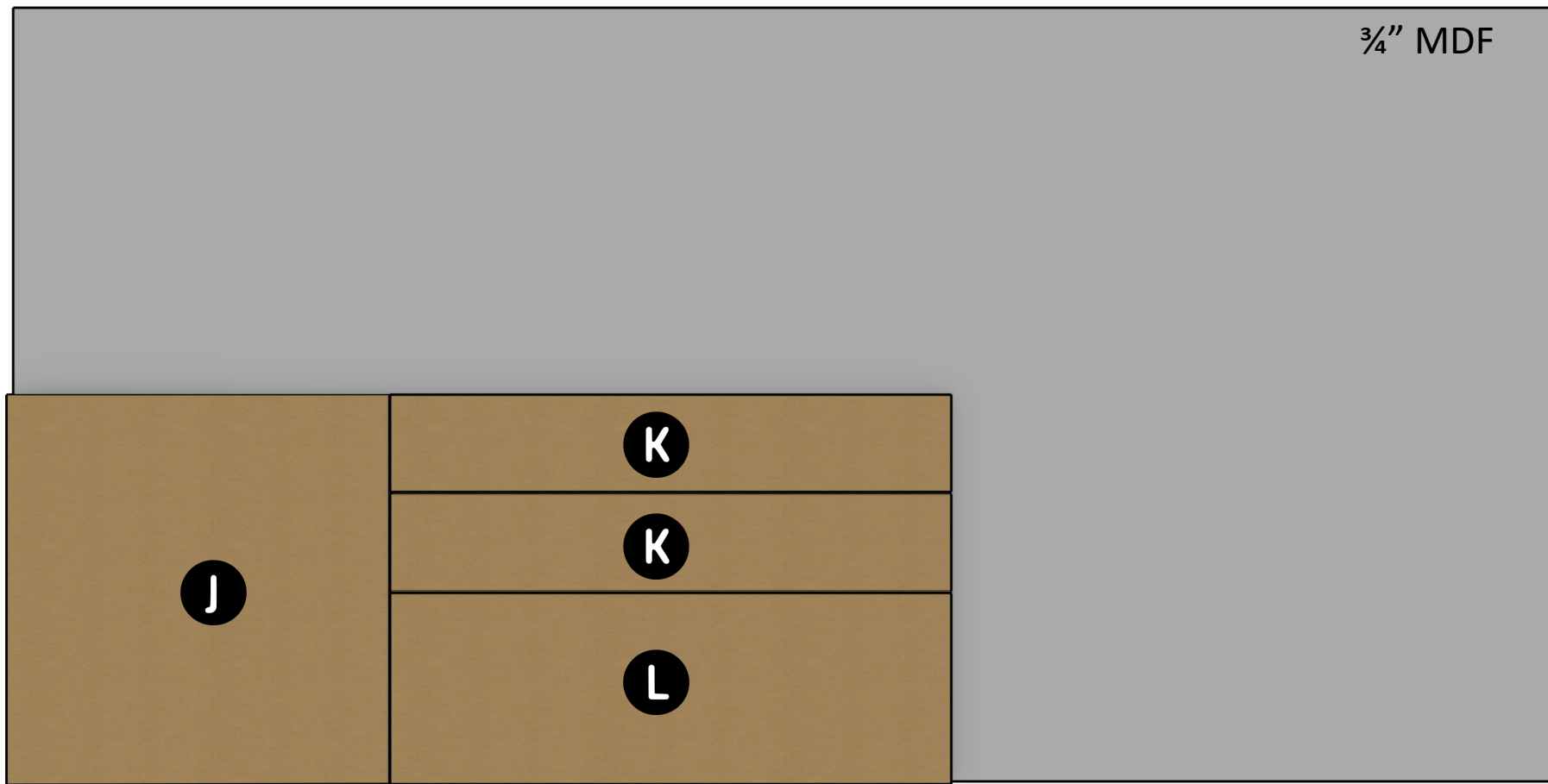

Drawer Box and Tray Prep

- Mill all parts according to the cut list.
- Add a $\frac{1}{4}$ " groove, $\frac{3}{8}$ " deep, located $\frac{1}{2}$ " from the bottom on the sides on parts (W), (U), (S), and (Q).
- Add a $\frac{5}{8}$ " wide, $\frac{3}{8}$ " deep dado, located $\frac{1}{2}$ " from the bottom of each side of the tray parts (M), (N), and (O)
- Nibble out a notch in the back of both (M) Tray Backs to allow space for the undermount drawer slides.
- Add pocket holes to the front and backs of the drawers. Tray will not get pocket holes.
- Pocket hole setting should be set to $\frac{5}{8}$ " thickness and 1" screw.
- See video for drawer box construction details.

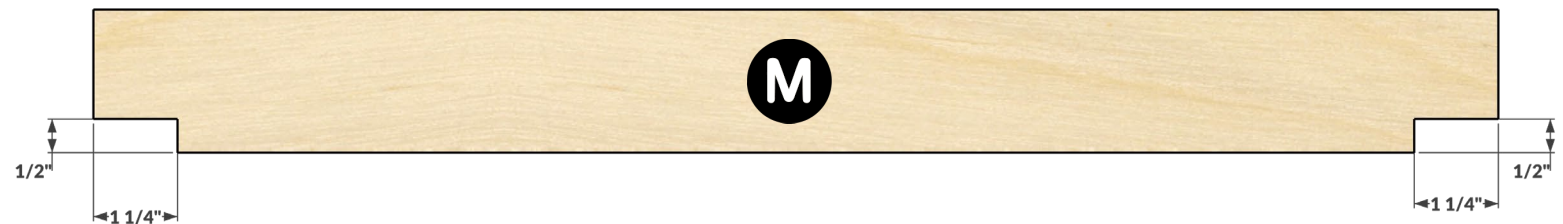
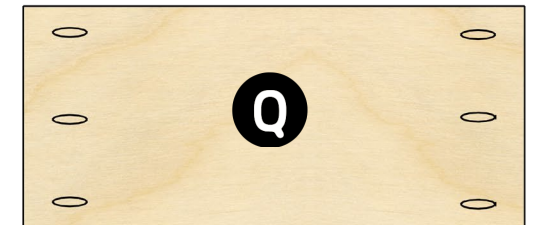
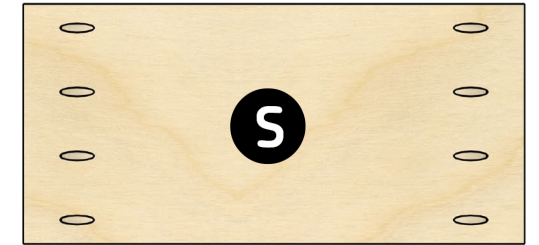
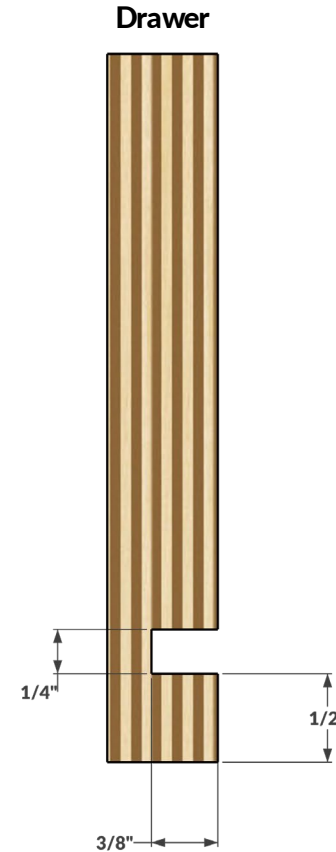
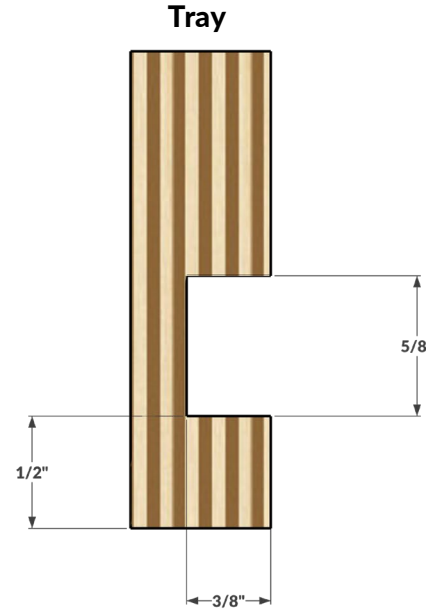

Drawer Slide Placement

- Refer to video and manufacturer's instructions for installation.
- Install the slide starting at the top using a spacer. Then cut the spacer to the next lowest set of slides. Then bottom slides are flush with the bottom of the cabinet.

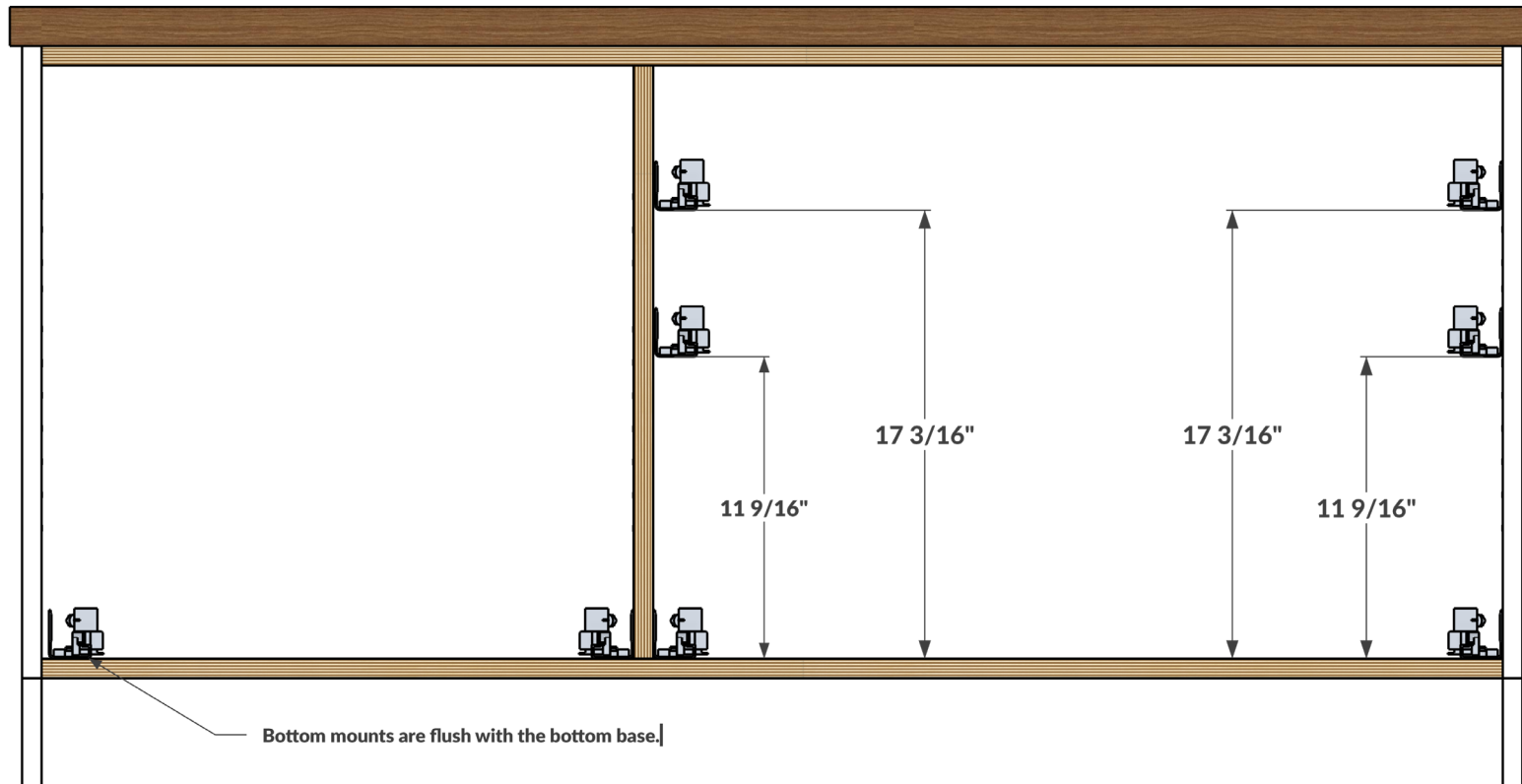

Shelf Details

- Mill the (X) shelf according to the cut list
- Add edge banding to the front sides of the shelf
- Insert ¼" shelf pins in the holes of your choice and place shelf on top.

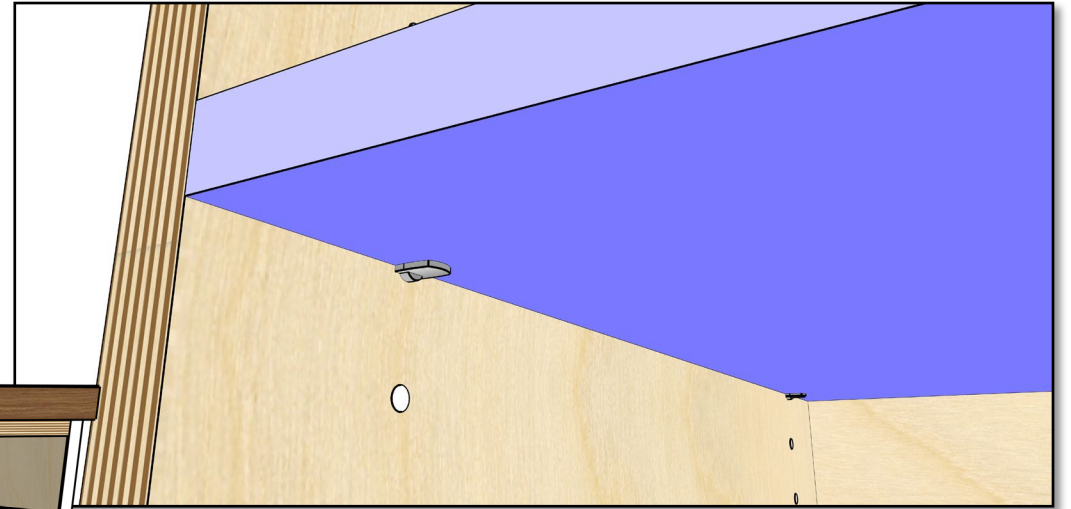
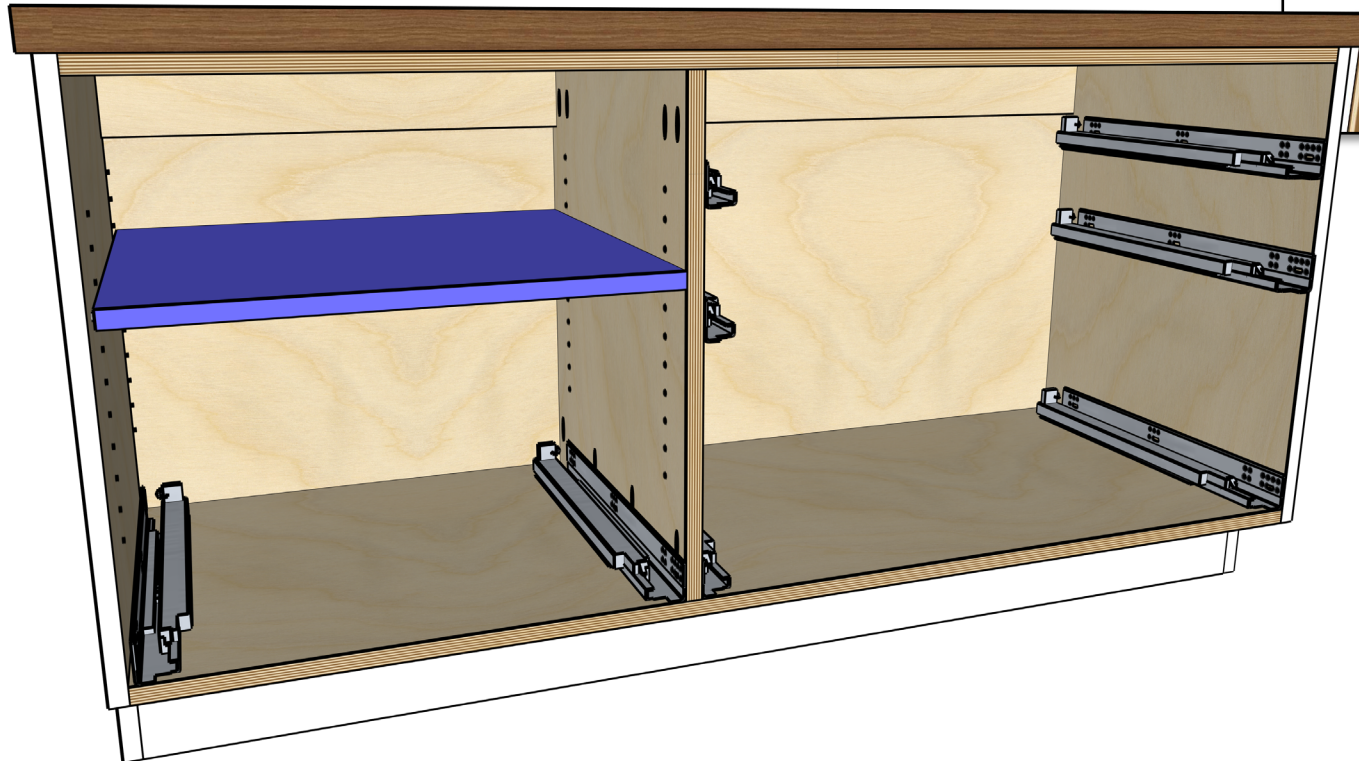

Drawer Fronts and Doors

- Use a hinge jig and bore out holes for the cup hinges.
- Note the bottom hinge is slightly higher to avoid the bottom tray.
- Install the doors with a 1/8" reveal at the bottom.
- Adjust the hinges if needed.
- Add the drawer fronts with spacers. The reveal is 1/8".
- Once placed, secure to the drawer from the back of the drawer boxes with screws.
- Install the finger pull handles by centering them on the drawer fronts and on the top inside corners of the doors.
- See Video for complete details.

